

- 1
- 2
- 3
- 4
- 5
- 6
- 7
- 8
- 9
- 10
- 11
- 12
- 13
- 14
- 15
- 16
- 17
- 18

TYPES

- Type **A**: without no-slip disk
- Type **B**: with no-slip disk
- Type **C**: with O-ring

Steel
epoxy resin coating
black, RAL 9005, textured finish

No-slip disk
black, NBR
85±5 Shore A

O-ring
black, NBR
≈ 70 Shore A

FEATURES AND APPLICATIONS

Foot plates GN 36.1 are characterized by their solid construction and large variety. They are used especially on large and heavy systems and machines.

The foot plates are ideal for use with customized adjustment or compensation stems that have the spherically shaped absorption radius "r" at the contact point. DIN screws or threaded studs with chamfer or pointed nose used as an alternative reduce the load capacity due to the lack of full-surface contact.

Type B with rubber underlay prevents slipping to the side, protects delicate surfaces and dampens vibrations and tremors. Type C with O-ring provides a seal over the ground to prevent the build-up of dirt under the foot.

ON REQUEST

- Zinc plated, blue passivated surface
- Surface available in other colors (epoxy resin coating)
- other geometries at the contact point

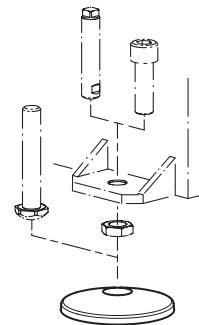

Conversion Table	
1 mm = 0.039 inch	
mm	inch
80	3.12
100	3.90
125	4.88
160	6.24
200	7.80

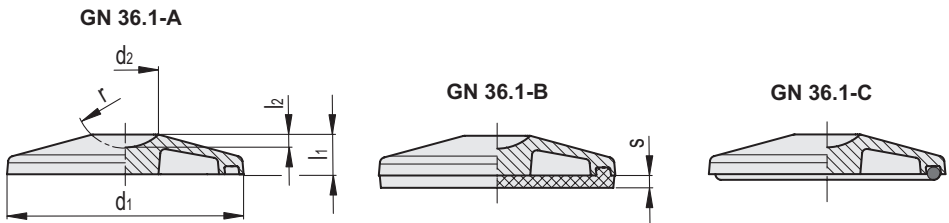

GN 36.1-A

Code	Description	d1	d2	l1	l2	r	Static load [kN]	⚖
GN.33201	GN 36.1-80-R20-A	80	25.5	15	4.6	R20	110	275
GN.33211	GN 36.1-100-R20-A	100	25.5	17.5	4.6	R20	110	458
GN.33221	GN 36.1-125-R25-A	125	32	21	5.8	R25	170	860
GN.33231	GN 36.1-160-R30-A	160	38.5	27	7	R30	250	1761
GN.33241	GN 36.1-200-R35-A	200	45	33	7.9	R35	340	3367

GN 36.1-B

Code	Description	d1	d2	l1	l2	r	s	Static load [kN]	⚖
GN.33202	GN 36.1-80-R20-B	80	25.5	15	4.6	R20	3	20	296
GN.33212	GN 36.1-100-R20-B	100	25.5	17.5	4.6	R20	4	30	503
GN.33222	GN 36.1-125-R25-B	125	32	21	5.8	R25	5	50	944
GN.33232	GN 36.1-160-R30-B	160	38.5	27	7	R30	6	70	1928
GN.33242	GN 36.1-200-R35-B	200	45	33	7.9	R35	8	110	3700

GN 36.1-C

Code	Description	d1	d2	l1	l2	r	Static load [kN]	⚖
GN.33203	GN 36.1-80-R20-C	80	25.5	15	4.6	R20	110	278
GN.33213	GN 36.1-100-R20-C	100	25.5	17.5	4.6	R20	110	465
GN.33223	GN 36.1-125-R25-C	125	32	21	5.8	R25	170	870
GN.33233	GN 36.1-160-R30-C	160	38.5	27	7	R30	250	1782
GN.33243	GN 36.1-200-R35-C	200	45	33	7.9	R35	340	3394

METRIC

Levelling feet and supports